

PRO-12

Ultrasonic humidifier

Helps you quickly
normalize the
humidity in the
room

EN



1. INTRODUCTION

Thank you for purchasing B.Well cool mist humidifier!

Product was developed, verified and supervised by B.Well Swiss AG, Switzerland. Applied Swiss control system assures high quality, endurance and safety of all B.Well products. PRO-12 helps you quickly normalize the humidity in the room using cool mist.

Please read through these instructions carefully so that you understand all functions and safety information. We want you to be happy with your B.Well product.

B.Well is guaranteeing that this humidifier is made of high quality materials and meets current national and international safety standards.

2. MAIN BENEFITS

- Top fill structure
- Easy handling
- Adjustable mist knob control, from low to high
- Auto Power off when waterless (Dry boil protection)
- Large capacity (5L)

3. PRO-12 OVERVIEW

- 1 mist nozzle
- 2 water tank cover
- 3 handle
- 4 filter
- 5 water tank
- 6 water window
- 7 floater
- 8 base
- 9 switch ON/OFF/mist level control
- 10 air outlet
- 11 power cord
- 12 transducer

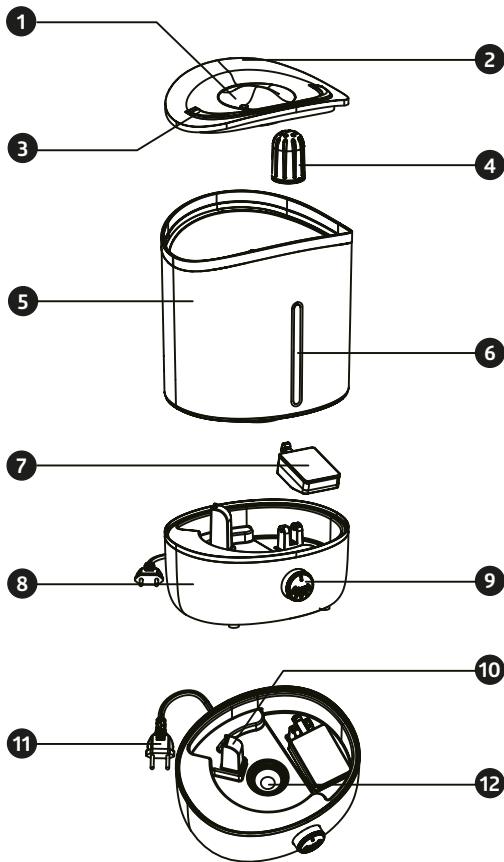

4. INSTRUCTIONS FOR USE

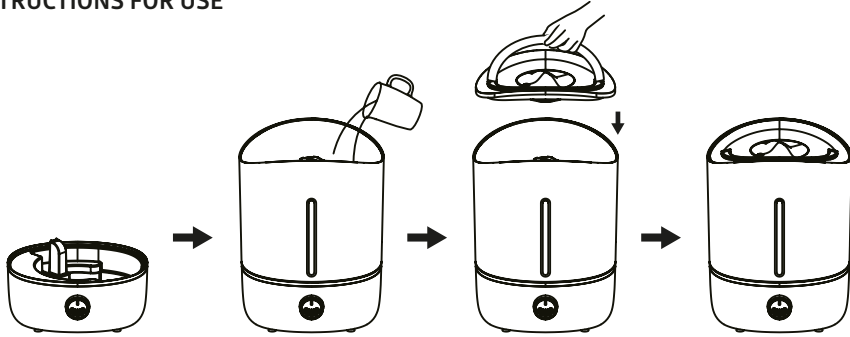

<p>1</p>	<p>Find a suitable flat surface* near an electrical outlet to place the humidifier on. Locate the humidifier at least 60 cm above the floor, 30 cm away from the walls or any objects.</p> <hr/> <p>*DO NOT place the humidifier on an uneven surface (such as a high pile carpet). Make sure the humidifier is not near the furniture or electronics.</p>	
<p>2</p>	<p>Lift the water tank cover with handle and fill it with cool* distilled or filtered water (not higher than 40 °C).</p> <hr/> <p>*DO NOT use hot water.</p>	
<p>3</p>	<p>Plug in the appliance into the socket.</p>	
<p>4</p>	<p>Turn the knob control clockwise to activate the steam.</p>	
<p>5</p>	<p>Turn the knob control to adjust the steam output speed. Turning the knob clockwise increases steam formation.</p>	
<p>6</p>	<p>Turn the mist nozzle to set the required direction of steam flow.</p>	
<p>7</p>	<p>When the water tank is empty or the water reaches a minimum level, the humidifier will automatically shut down and stop producing moisture.</p>	
<p>8</p>	<p>Turn off the humidifier by turning the knob control counterclockwise. You will hear the click.</p>	
<p>9</p>	<p>Unplug the power cord.</p>	

5. TECHNICAL SPECIFICATIONS

Model	PRO-12
Type	Ultrasonic
Voltage (V)	100-240 V
Frequency (Hz)	50 Hz
Power (W)	30W (+/-20%)
Capacity (L)	5 L
Mist volume (ml/h)	Max 250ml/h(+/-20%)
Steam temperature: cold	30 °C
Top water refill	+
Humidity modes	knob control, from low to high
Adjusting the intensity of evaporation	Turn the knob control
Warning if there is no water	Yes, Auto Power off when waterless (dry boil protection)
Waterless autoshtutdown	at once
Noise (dB)	<35 dB(A)
Type	Class II
Size (l*w*h)	22.5 cm x 22.5 cm x 32,3 cm
Weight	1,43 kg
Operation environment, temperature	+5 °C – +60 °C
Storage and transportation environment, temperature	-20 °C – +60 °C
In set	Humidifier – 1 pc Brush – 1 pc Instruction manual with warranty card – 1 pc

6. CLEANING AND MAINTENANCE

⚠ ATTENTION!
Change the water daily to avoid bacteria growth.

DO NOT leave water inside the water tank if you not use the humidifier longer than 1 week. Clean it and dry instead.

DO NOT clean immediately after turning it off.

🕒 NOTE!

Before cleaning, you must turn off the power supply and pull out the plug from the outlet. Wipe the descaling tank every 2-3 weeks with a soft cloth (detergent is acceptable) and rinse it with water. Use a damp cloth to clean the outer case of the instrument. When cleaning the transducer, if there is any coating on the surface, it can be wiped off with a swab and then rinsed with clean water.

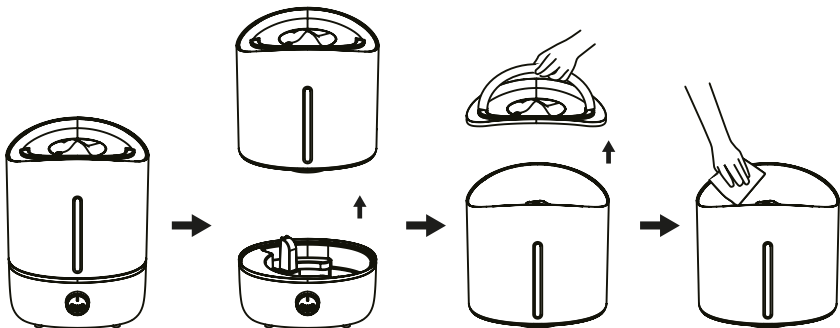

1	Turn off and unplug the humidifier.
2	Remove the water tank from the pedestal.
3	Remove the water tank cover and pour out any remaining water.
4	Fill some acid cleaner (citric acid or acetic acid) in the water tank for around 15 minutes, then descale with a cleaning brush. Clean all parts of the water reservoir with a soft cloth. DO NOT submerge the pedestal in water.

7. POSSIBLE TROUBLESHOOTING AND SOLUTIONS

TROUBLE	CAUSE AND SOLVING
The appliance does not turn on	No power supply or the power cord is damaged. Connect the power supply or contact the service center.
The mist volume is low and the water column sprays out after the humidifier is turned on	There can be an incrustation on atomizing piece or the humidifier has been stored for a long time without using. Clean atomizing space with a swab and inject new water.
The mist produces an unpleasant smell	Change the water regularly to avoid dirty water accumulation. Open the tank cap and keep the tank open for 12 hours, then clean it and refill it with water.
Atomizing is discontinuous when the product is turned on	DO NOT worry. It will become normally after a while.
Atomizing is insufficient	Air inlet is blocked. Check the air inlet.
There are some white deposits in the water tank	You need to descale the humidifier regularly. Using purified or distilled water can help prevent the formation of scale.
Condensation forms around humidifier	1. Humidity may be too high. Turn down the mist level, turn off the humidifier or open a door or window to the room. 2. Air inlet is blocked, humidifier should be placed on a hard flat surface, 60 cm above the floor, 30 cm away from the wall. 3. Low indoor temperature leads to liquefaction, raise the room temperature to 25 °C/77 °F.

8. CONTRAINDICATIONS AND PRECAUTIONS



PLEASE READ THE USER MANUAL CAREFULLY BEFORE USING THE PRODUCT.

- This appliance is intended for domestic and indoor use only.
- DO NOT let children play with the appliance.
- This appliance is not intended for use by persons (including children) with reduced physical, sensory or mental capabilities, or lack of experience and knowledge, unless they are supervised or instructed in the use of the appliance by a person responsible for their safety.

The following safety precautions must be observed:

- DO NOT try to pull the plug out of the socket with a wet hand to avoid electric shock.
- If the body of the instrument is tilted, turn off the power before operating.
- After starting, DO NOT touch the transducer, otherwise you will feel pain.
- DO NOT change the power cord by yourself.
- The power cord must not be scratched, damaged, excessively bent, knotted, otherwise it may cause a short circuit and fire.
- DO NOT place the humidifier near flammable, corrosive gases or conductive dust.
- Never immerse the housing in liquid or pour liquid into or on the housing. Doing so may damage the humidifier and cause injury.
- Always unplug the appliance before assembling, disassembling or cleaning, and when not in use.
- Use the humidifier as far away from furniture and electrical products as possible.
- DO NOT touch the transducer unit during operation.
- DO NOT turn on the device if the water tank is empty.
- DO NOT immerse the base of the main unit in water.
- Turn off the power before cleaning or servicing the device.
- Enter clean water below 40°C.
- DO NOT allow water to enter the base from the air outlet. If there is water on the case, wipe the outside of the humidifier with a dry soft cloth.
- Please empty the water from the tank and trough if the ambient temperature is below 0.
- Use this device only on a flat, level surface. This unit may not work properly if it is placed on an uneven surface or to prevent water from overflowing from the chute.
- DO NOT install the humidifier near furnaces, heaters, stoves or any other heat source.
- DO NOT add water directly to the mist nozzle.
- DO NOT use anything other than water in this appliance. DO NOT use supplements.

9. GUARANTEE OBLIGATIONS

Warranty period is 2 years.

This warranty doesn't cover any damages caused by improper using.

The policy of the company B.Well provides constant improvement of products. Therefore, the company reserves the right to make complete or partial changes to the products without prior notice and in accordance with production requirements.

The date of manufacture of the device is specified in the LOT number indicated in warranty card and on the device. The first and second digits are the week number, the third and fourth are the year of production.

10. WARRANTY

LOT number (LOT): _____







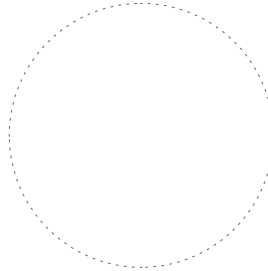



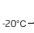

Date of sale: _____

Seller's signature: _____

Seal of seller's company:



11. DESCRIPTION OF THE SYMBOLS USED ON THE PACKAGE

	REFER TO INSTRUCTION MANUAL BEFORE USE	 5°C - 60°C OPERATION CONDITION	OPERATING CONDITION, TEMPERATURE		MANUFACTURER'S NAME
	CE MARK	 -20°C - 60°C STORAGE CONDITION	STORAGE CONDITION, TEMPERATURE		ARTICLE NUMBER
	DISPOSAL FOR SEPARATE COLLECTION		FOR INDOOR USE ONLY		LOT NUMBER
	KEEP DRY		CLASS OF PROTECTION AGAINST ELECTRIC SHOCK (CLASS II)		RECYCABLE

Last revision 2023-W20

B.Well Swiss AG,
Bahnhofstrasse 24, 9443 Widnau,
Switzerland

**Ultrasonic humidifier
B.Well PRO-12**

DEVICE IS NOT A MEDICAL PRODUCT

 **B.Well Swiss AG**
Bahnhofstrasse 24, 9443 Widnau, Switzerland
www.bwell-swiss.ch

B.Well 
Caring for everyone